

FOR SALE



20/2 Doyalson Place, Helensvale

All offers presented and considered prior to Monday the 29th July 4pm.

Situated in the well presented "Lindfield Close" complex, this townhouse offers an exceptional lifestyle in the vibrant heart of Helensvale.

Nestled in a highly sought-after area, this townhouse is just a short stroll from Westfield Shopping Centre, ensuring you have access to a wide array of retail outlets, dining options, and entertainment. The proximity to train and tram stations guarantees seamless connectivity to the rest of the Gold Coast and beyond. Local shops, Helensvale State School, and the library are also within walking distance, making daily errands and school runs effortless....

...

3  2  2 

Price: Best offer over \$695,000 by Monday 29th July 4pm

View: <https://remaxpropertycentre.com.au/8072227>

Danny Woolbank

M 0414 946 127



KB Seo

0431 142 818



RE/MAX Property Centre

Shop 6/110 Monaco Street

07 5629 7735

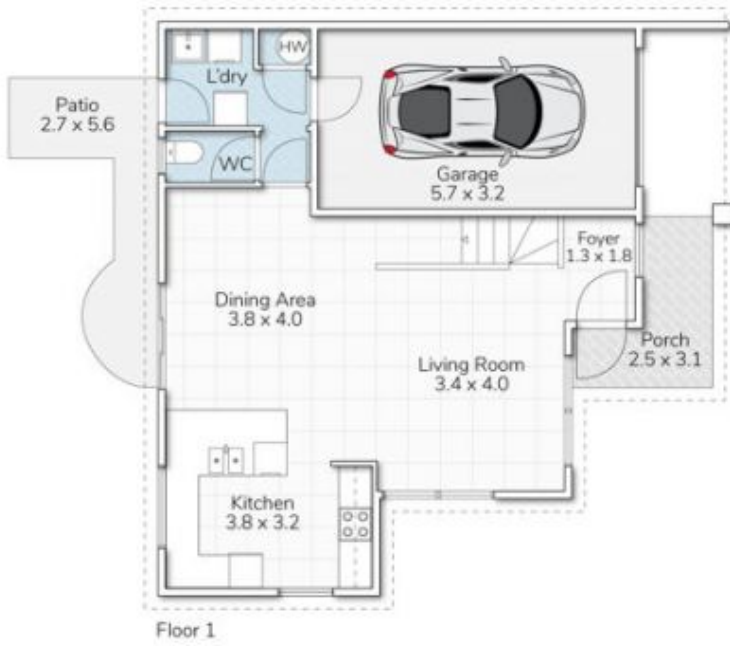

20/2 DOYALSON PLACE, HELENSVALE

This floor plan is for marketing purposes only. Dimensions and layout are approximate. Mounfort Media gives no guarantee or warranty over the accuracy of this plan.



INTERNAL AREA:	112M ²
EXTERNAL AREA:	50M ²
TOTAL AREA:	162M ²
	3
	2
	1